

# \$1,300,000 - 10255 86 Street, Grande Prairie

---

MLS® #A1194189

**\$1,300,000**

0 Bedroom, 0.00 Bathroom,  
Land on 3.11 Acres

Crystal Landing, Grande Prairie, Alberta

Vacant land in Crystal Landing!!! This 3.11 acres is a multi-family site and zoned RM. Kids park to the right of property and in a family neighborhood. All inquiries pls contact Jason Scott!!

## Essential Information

MLS® #	A1194189
Price	\$1,300,000
Bathrooms	0.00
Acres	3.11
Type	Land
Sub-Type	Residential Land
Status	Active

## Community Information

Address	10255 86 Street
Subdivision	Crystal Landing
City	Grande Prairie
County	Grande Prairie
Province	Alberta
Postal Code	T8X 0B5

## Amenities

Utilities	None
-----------	------

## Exterior

Lot Description	Landscaped
-----------------	------------

## Additional Information

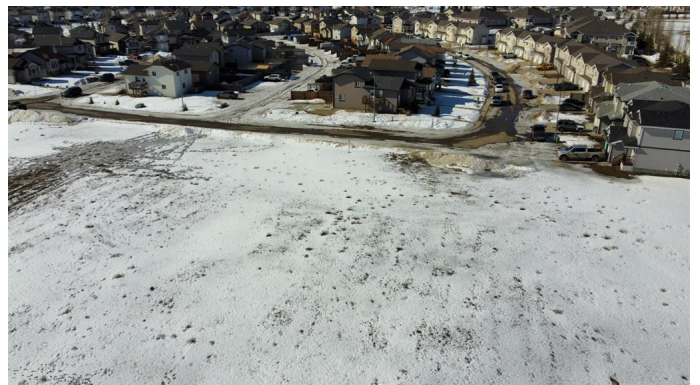
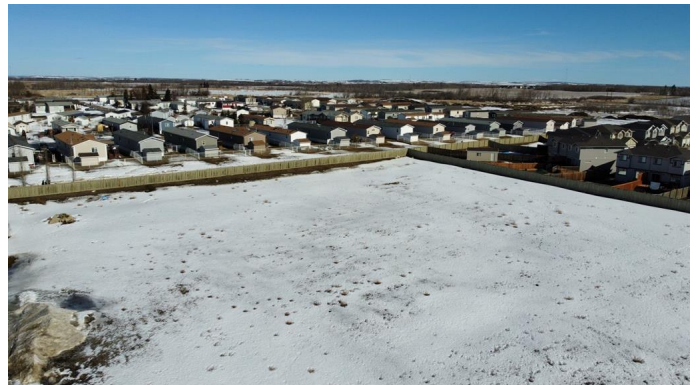

Date Listed	March 15th, 2022
Days on Market	1255
Zoning	RC

## **Listing Details**

Listing Office	Sutton Group Grande Prairie Professionals
----------------	---

Data is supplied by Pillar 9â„¢ MLS® System. Pillar 9â„¢ is the owner of the copyright in its MLS® System. Data is deemed reliable but is not guaranteed accurate by Pillar 9â„¢. The trademarks MLS®, Multiple Listing Service® and the associated logos are owned by The Canadian Real Estate Association (CREA) and identify the quality of services provided by real estate professionals who are members of CREA. Used under license.