

# \$249,900 - 11401 Belgrave Road, Rural Grande Prairie No. 1, County of

---

MLS® #A2202932

**\$249,900**

0 Bedroom, 0.00 Bathroom,  
Land on 0.54 Acres

Carriage Lane Estates, Rural Grande Prairie  
No. 1, County of, Alberta

**PRIME LOCATION, BACKING ONTO POND!**

Looking to build your dream home? Look no further than 0.54 acres of land ready to build on backing onto the pond in Carriage Lane Estates. Take advantage of the space and low county taxes today!



## Essential Information

|           |                  |
|-----------|------------------|
| MLS® #    | A2202932         |
| Price     | \$249,900        |
| Bathrooms | 0.00             |
| Acres     | 0.54             |
| Type      | Land             |
| Sub-Type  | Residential Land |
| Status    | Active           |

## Community Information

|             |                                 |
|-------------|---------------------------------|
| Address     | 11401 Belgrave Road             |
| Subdivision | Carriage Lane Estates           |
| City        | Rural Grande Prairie No. 1, C   |
| County      | Grande Prairie No. 1, County of |
| Province    | Alberta                         |
| Postal Code | T8X0G4                          |

## Additional Information

|                |                  |
|----------------|------------------|
| Date Listed    | March 17th, 2025 |
| Days on Market | 57               |

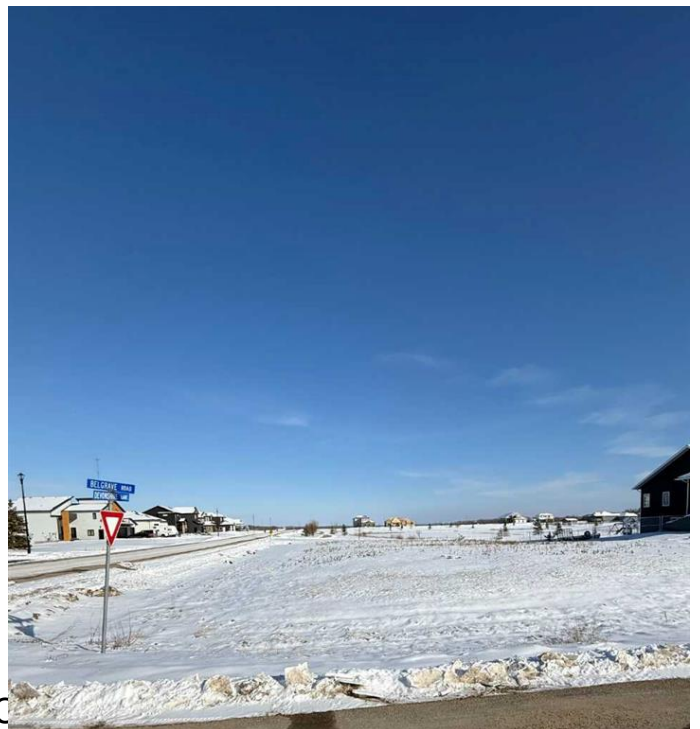

Zoning

RE

Listing Details

Listing Office

Grassroots Realty Group Ltd.

Data is supplied by Pillar 9â„¢ MLS® System. Pillar 9â„¢ is the owner of the copyright in its MLS® System. Data is deemed reliable but is not guaranteed accurate by Pillar 9â„¢. The trademarks MLS®, Multiple Listing Service® and the associated logos are owned by The Canadian Real Estate Association (CREA) and identify the quality of services provided by real estate professionals who are members of CREA. Used under license.